

OUTPUT SHAFT COUPLING & PROPELLER COUPLING DIMENSION

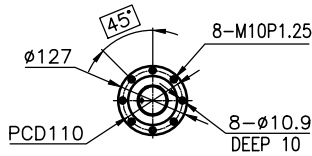

INPUT COUPLING DIMENSION

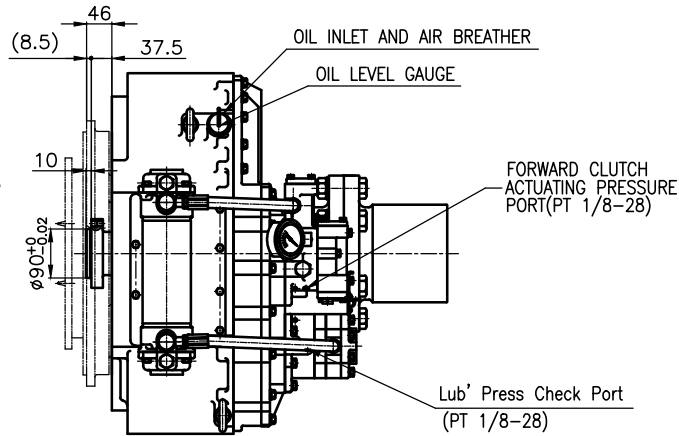

DMT180HL MARINE TRANSMISSION SPECIFICATION	
GEAR RATIO	5.15, 5.96
TOTAL WEIGHT	APPROX. 475 Kg(DRY)
OIL CAPACITY	APPROX. 18 L
OIL VISCOSITY	SAE # 30
OIL PRESSURE	1.96 ~ 2.54 MPa CLUTCH OIL
DIRECTION OF ROTATION IN FORWARD	INPUT C.C.W VIEWED FROM THE STERN OUTPUT C.W VIEWED FROM THE STERN
OIL CHANGE INTERVAL	THE FIRST 100HOURS OF INITIAL OPERATION AND EVERY 1000HOURS THEREAFTER
SHIFTING LIMIT	UNDER 50% OF THE RATED ENGINE SPEED
OIL COOLER	WATER FLOW 40 ~ 60 L/m
	TEMPERATURE OF COOLING WATER MAX 32°C
OPERATING TORQUE OF SHIFTING LEVER	UNDER 2.94Nm

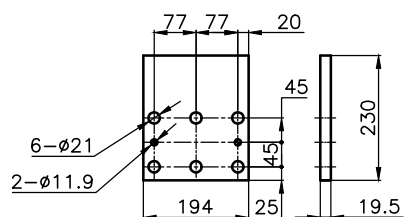
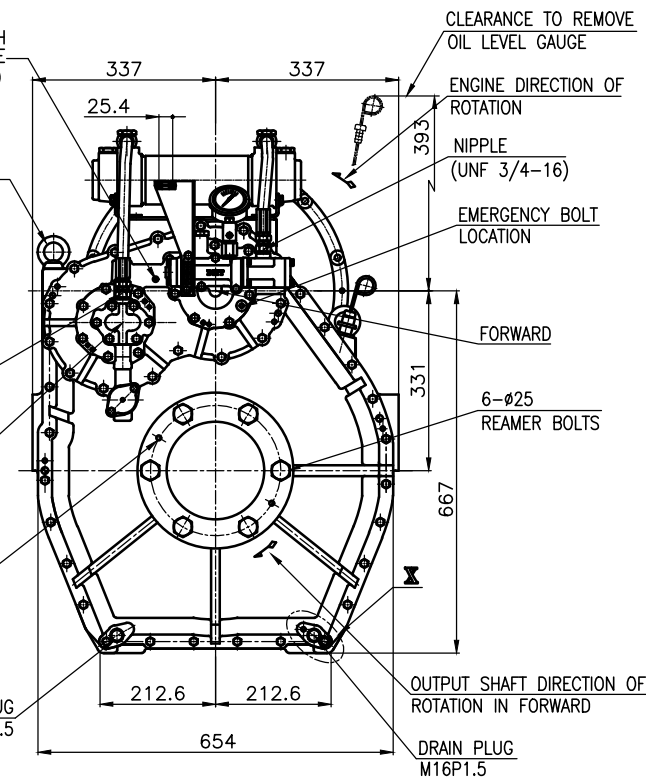
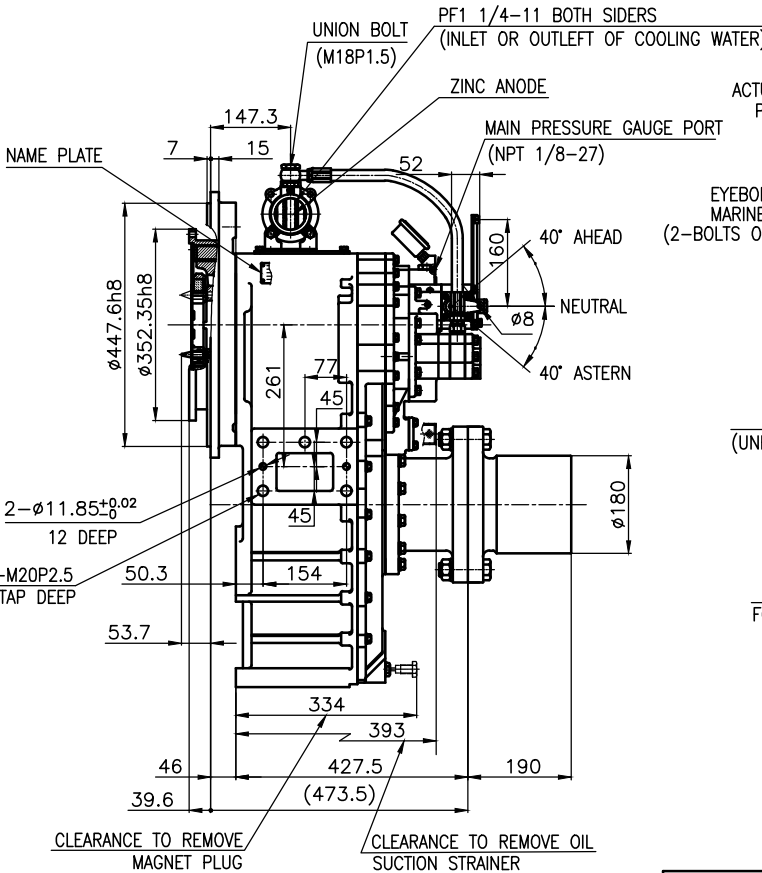
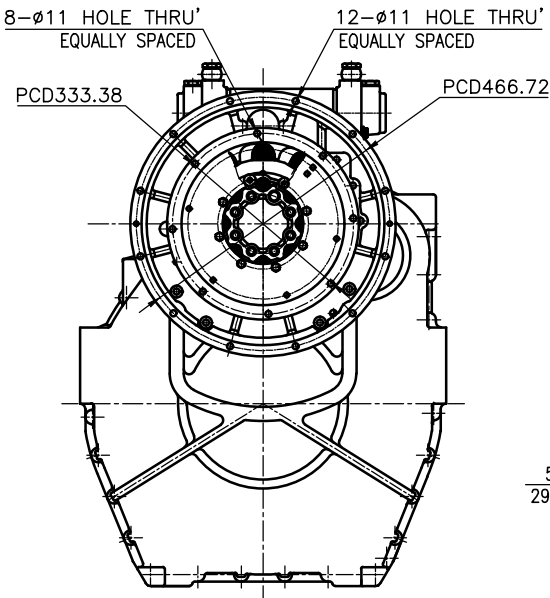

BRACKET DIMENSION

- REMARK (HOT)  
 1.HOUSING: SAE#2  
 2.DRIVING RING: SAE 11.5"  
 3.COUPLING TYPE : DUAL STAGE  
 4.APPLICATION ENGINE : STANDARD

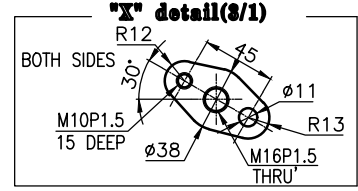

TOLERANCE ON		PART NO.		PART NAME		QTY	MATERIAL	SIZE	REMARKS
FRACTIONS	DECIMALS	NO.	REV.	NAME	REV.				
±	±			DATE		SCALE	TYPE		
±	±			2018.09.12		N/S	DMT180HL		
±	±			APPROVED BY		DESIGNED	ORIGINAL DWG. NO.		
±	±			JK.Kim		GH.Park	MARINE TRANSMISSION		
±	±			CHECKED BY		TH.Cha	DWG. NO.		
±	±			1호과 4이하			18000GHA~B-2115DCH		
±	±			4			REV.		
±	±			16			000		
±	±			63					
±	±			250					
±	±			1000					