

OUTPUT SHAFT COUPLING & PROPELLER COUPLING DIMENSION

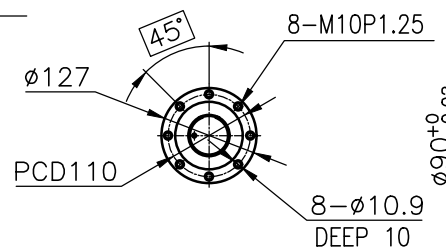

INPUT COUPLING DIMENSION

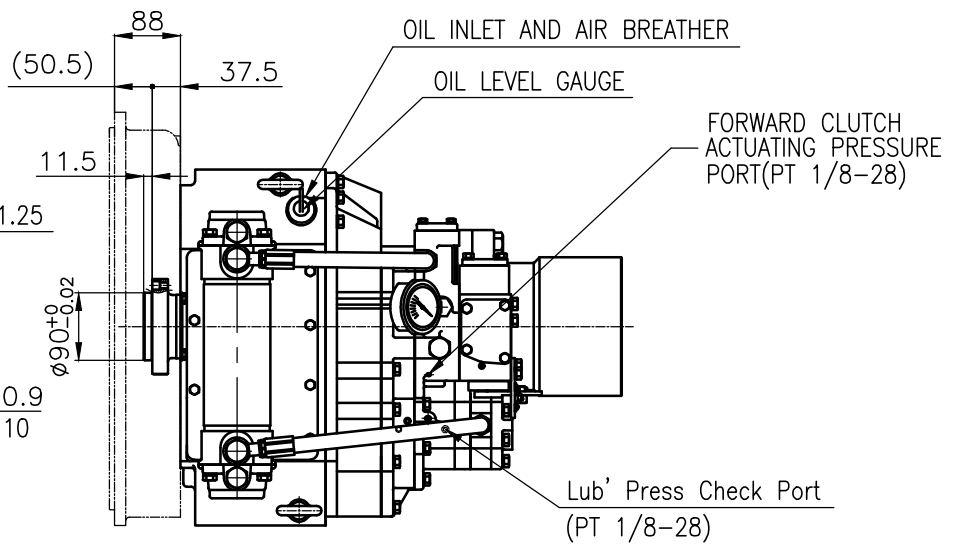

GEAR RATIO	1.83, 2.09, 2.52, 3.08, 3.43		
TOTAL WEIGHT	APPROX. 300 kg(DRY)		
OIL CAPACITY	APPROX. 5.5 L		
OIL VISCOSITY	SAE # 30		
OIL PRESSURE	1.96 ~ 2.35 MPa	CLUTCH OIL	
DIRECTION OF ROTATION	INPUT	C.C.W VIEWED FROM THE STERN	
	OUTPUT	C.W VIEWED FROM THE STERN	
OIL CHANGE INTERVAL	THE FIRST 100HOURS OF INITIAL OPERATION AND EVERY 1000HOURS THEREAFTER		
SHIFTING LIMIT	UNDER 50% OF THE RATED ENGINE SPEED		
OIL COOLER	WATER FLOW 40 ~ 60L/min		TEMPERATURE OF COOLING WATER
OPERATING TORQUE OF SHIFTING LEVER	UNDER 2.94Nm		

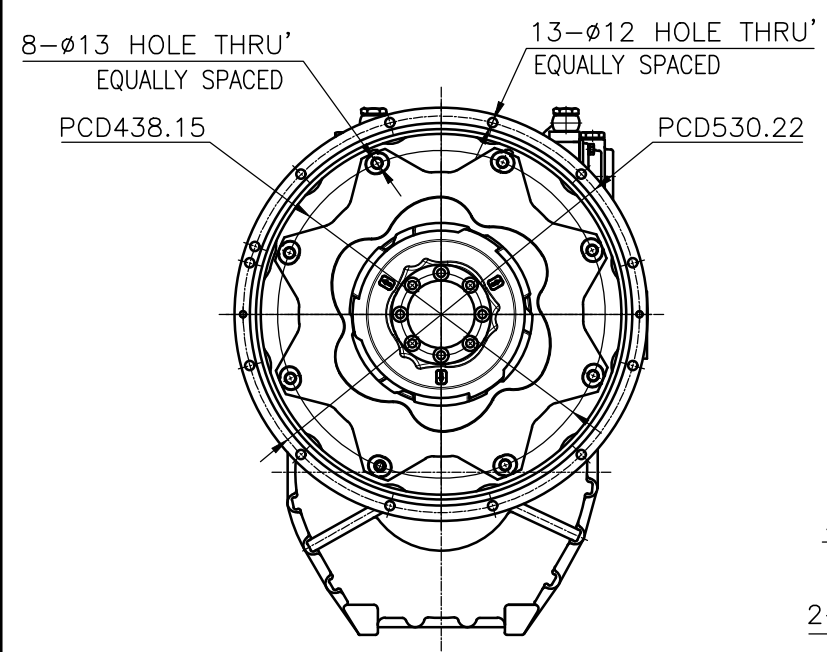

- REMARK
 1. HOUSING: SAE#1
 2. DRIVING RING: SAE 14"
 3. COUPLING TYPE
 -CENTA Flex Coupling : 77216801
 4. APPLICATION ENGINE : STANDARD

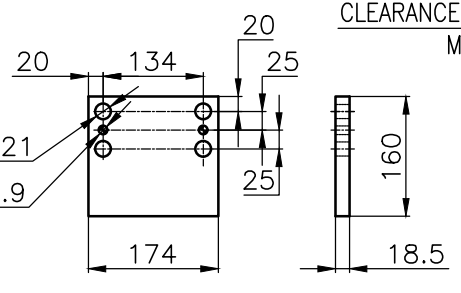
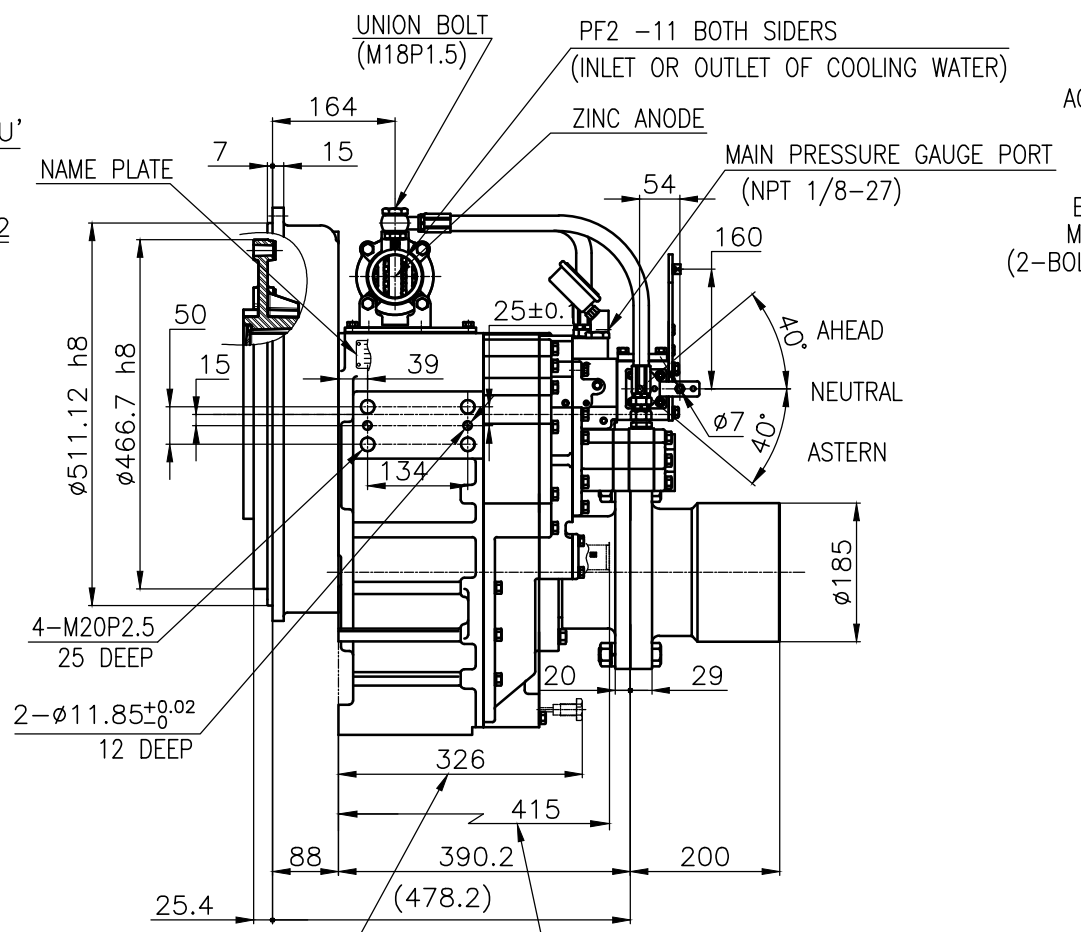

BRACKET DIMENSION

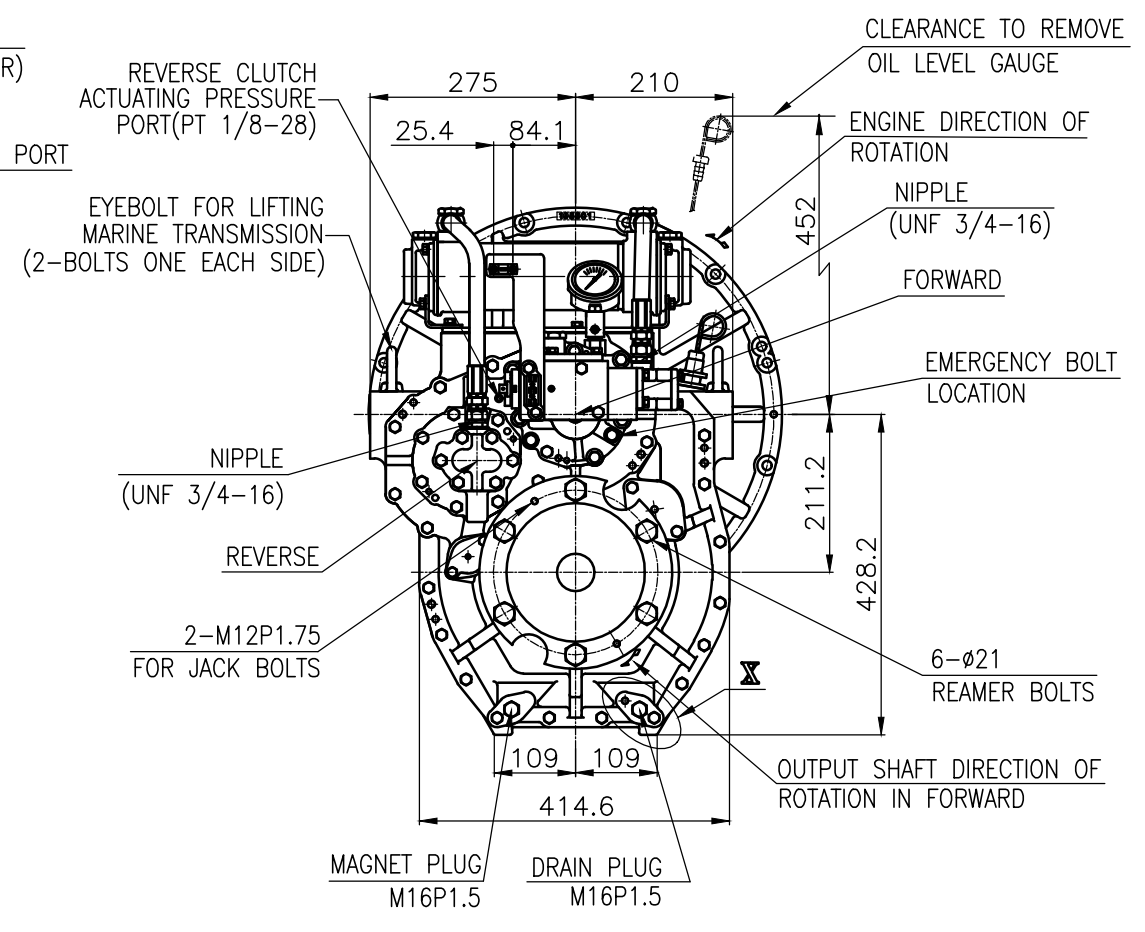
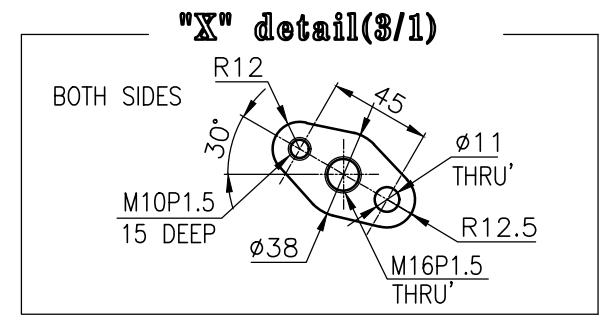

공통공차	TOLERANCE ON	번호	PART NO.	PART NAME	개수	MATERIAL	규	SIZE	비	REMARKS
분수	소수	각도								
±	±	±								
±	±	±								
필수		작성 DATE 2018.09.12								
필수		SCALE 1/1								
필수		인		검		제		설		
필수		APPROVED BY		CHECKED BY		DRAWN		DESIGNED		
필수		JK.Kim		TH.Cha		GH.Park				
필수		1 초과 4 이하		±0.3 ±0.1 ±0.05						
필수		4 16		±0.5 ±0.2 ±0.07						
필수		16 63		±0.7 ±0.3 ±0.1						
필수		63 250		±1.2 ±0.5 ±0.2						
필수		250 1000		±2.0 ±0.8 ±0.3						
D-I INDUSTRIAL						크 기		A 3		
						CODE ID. NO.				