

OUTPUT SHAFT COUPLING & PROPELLER COUPLING DIMENSION

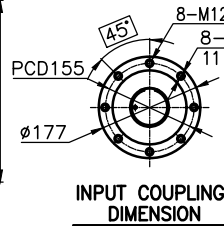

INPUT COUPLING DIMENSION

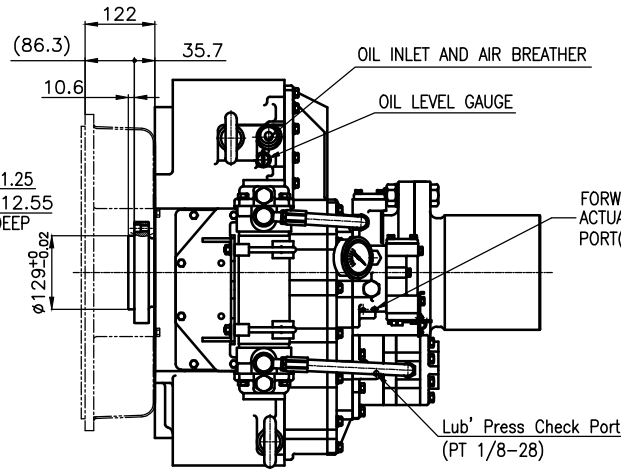

DMT260HL MARINE TRANSMISSION SPECIFICATION			
GEAR RATIO	3.53, 4.08, 4.52, 5.04		
TOTAL WEIGHT	APPROX. 640 Kg(DRY)		
OIL CAPACITY	APPROX. 19 L		
OIL VISCOSITY	SAE # 30		
OIL PRESSURE	1.96 ~ 2.54 MPa	CLUTCH OIL	
DIRECTION OF ROTATION	INPUT	C.C.W VIEWED FROM THE STERN	
IN FORWARD	OUTPUT	C.W VIEWED FROM THE STERN	
OIL CHANGE INTERVAL	THE FIRST 100HOURS OF INITIAL OPERATION AND EVERY 1000HOURS THEREAFTER		
SHIFTING LIMIT	UNDER 50% OF THE RATED ENGINE SPEED		
OIL COOLER	WATER FLOW 60 ~ 80 L/min		
	TEMPERATURE OF COOLING WATER		MAX 32°C
OPERATING TORQUE OF SHIFTING LEVER		UNDER 2.94Nm	

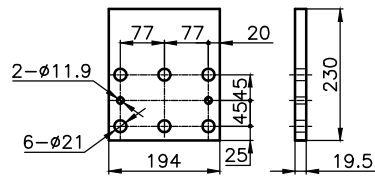
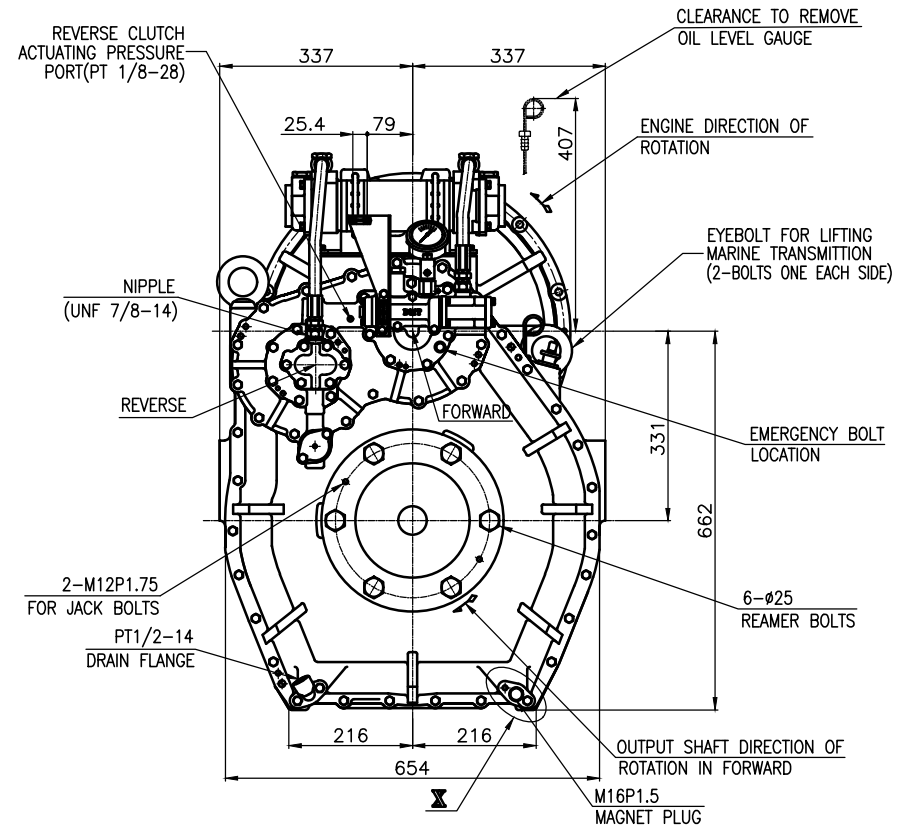
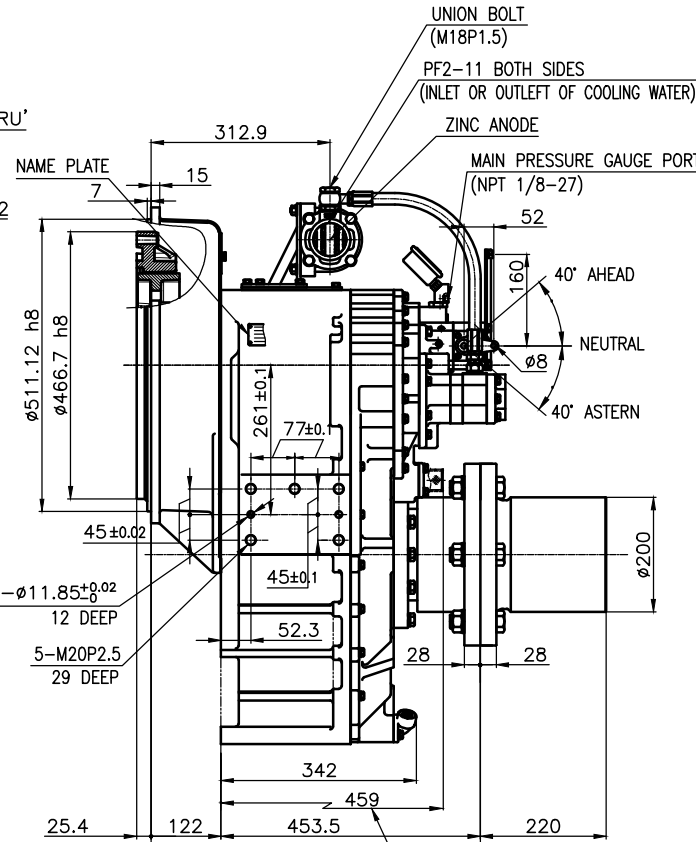
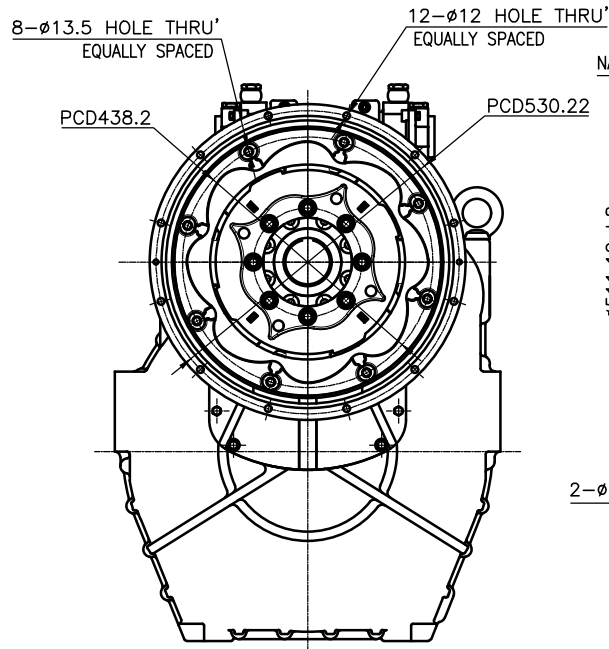

BRACKET DIMENSION

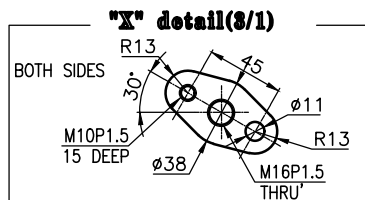

X detail(8/1)

- REMARK
 1. HOUSING: SAE#1
 2. DRIVING RING: SAE 14"
 3. COUPLING TYPE
 CENTA Flex Coupling (77268801)

공용공차	TOLERANCE ON	번호	PART NO.	명	PART NAME	개수	재료	구	비	고
분수	소수	각도						SIZE	REMARKS	
±	±	±								
1	0.3	0.1	±0.05	DATE	2018.09.12	SCALE	1/1	TYPE	DMT260HL	ORIGINAL DWG. NO.
4	±0.5	±0.2	±0.07	APPROVED BY	JK.Kim	CHECKED BY	TH.Cha	DESIGNED	GH.Park	NAME
16	±0.7	±0.3	±0.1	DWG. NO.	26000GA~C-114CFR	REV.	000	TYPE	MARINE TRANSMISSION	REV.
63	±1.2	±0.5	±0.2	SIZE	A 8	CODE ID. NO.				
250	±2.0	±0.8	±0.3	D-I INDUSTRIAL						